

Electric Power Fittings

Al Cable Terminals Non-Isolated - DL Type

OUMO PUBLISH

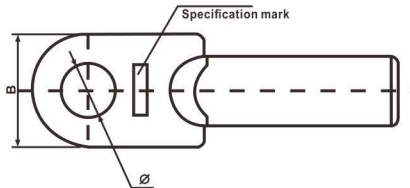
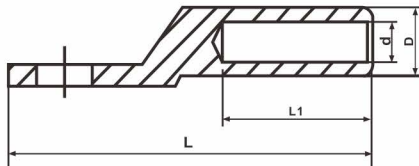

Specifications	Dimensions(mm)					Code No.
	Φ	D	d	L	L1	
DL-10	8.5	9	6	68	28	OMU-DL-001
DL-16	8.5	10	6	70	30	OMU-DL-002
DL-25	8.5	12	7	75	34	OMU-DL-003
DL-35	10.5	14	8.5	85	38	OMU-DL-004
DL-50	10.5	16	9.8	90	40	OMU-DL-005
DL-70	12.5	18	11.5	102	48	OMU-DL-006
DL-95	12.5	21	13.5	112	51	OMU-DL-007
DL-120	14.5	23	15	120	53	OMU-DL-008
DL-150	14.5	25	16.5	126	56	OMU-DL-009
DL-185	16.5	27	18.5	133	58	OMU-DL-010
DL-240	16.5	30	21	140	60	OMU-DL-011
DL-300	21	34	24	160	65	OMU-DL-012
DL-400	21	38	26	170	70	OMU-DL-013
DL-500	21	47	29	190	75	OMU-DL-014
DL-630	21	54	35	220	85	OMU-DL-015
DL-800	21	60	38	250	100	OMU-DL-016

These products are suitable for the conjunction of wire, cables in the distribution equipment and the electrical equipment. DT model copper cable lug is pressed with aluminium bar(L3).