

Electric Power Fittings

Copper Cable Terminals Non-Isolated - DTG Type

OUMO PUBLISH

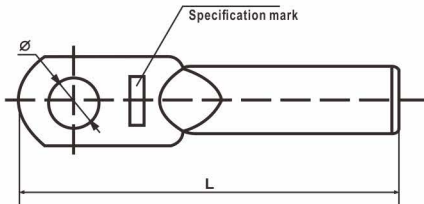
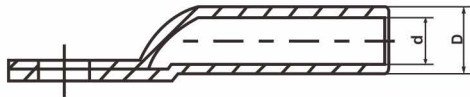

Specifications	Dimensions(mm)				Code No.
	D	d	Φ	L	
DTG-6	5.5	4.1	Φ5.2, Φ6.2, Φ8.2	47	OMU-DTG-001
DTG-10	8	6.6	Φ6.2, Φ8.2,	52	OMU-DTG-002
DTG-16	9	7	Φ6.2, Φ8.2, Φ10.5	57	OMU-DTG-003
DTG-25	9	7	Φ6.2, Φ8.2, Φ10.5, 12.5	62	OMU-DTG-004
DTG-35	10.5	8.5	Φ6.2, Φ8.2, Φ10.5, Φ12.5	66	OMU-DTG-005
DTG-50	12	9.8	Φ8.2, Φ10.5, Φ12.5	72	OMU-DTG-006
DTG-70	14.5	11.9	Φ8.2, Φ10.5, Φ12.5	81	OMU-DTG-007
DTG-95	16	13	Φ10.5, Φ12.5	85	OMU-DTG-008
DTG-120	19	15.4	Φ12.5, Φ16.5	97	OMU-DTG-009
DTG-150	20.5	16.7	Φ12.5, Φ16.5	101	OMU-DTG-010
DTG-185	23.5	19.3	Φ16.5	112	OMU-DTG-011
DTG-240	26	21.2	Φ16.5	119	OMU-DTG-012
DTG-300	30	24	Φ16.5, Φ20.5	132	OMU-DTG-013
DTG-400	34	27.6	Φ16.5, Φ20.5	150	OMU-DTG-014
DTG-500	38	31.6	Φ16.5, Φ20.5	170	OMU-DTG-015
DTG-630	45	37.6	Φ20.5	170	OMU-DTG-016

These products are applicable to the connection of wires in distribution equipment power supply cable with electronic apparatus. It is made of T2 copper tube by die cast and coated tin.