

# Electric Power Fittings

## Copper Connection Tubes - GTY Type

OUMO PUBLISH

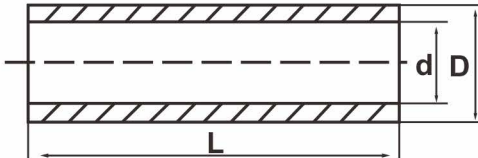

Specifications	Dimensions(mm)			Code No.
	D	d	L	
GTY-1.5	3.5	2.1	20	OMU-GTY-001
GTY-2.5	4	2.5	20	OMU-GTY-002
GTY-4	4.8	3.4	20	OMU-GTY-003
GTY-6	5.5	4.1	25	OMU-GTY-004
GTY-10	6.5	5.1	30	OMU-GTY-005
GTY-16	8	6.4	35	OMU-GTY-006
GTY-25	9	7	40	OMU-GTY-007
GTY-35	10.5	8.5	45	OMU-GTY-008
GTY-50	12	9.8	50	OMU-GTY-009
GTY-70	14.5	11.9	55	OMU-GTY-010
GTY-95	16	13	55	OMU-GTY-011
GTY-120	19	15.4	60	OMU-GTY-012
GTY-150	20.5	16.7	65	OMU-GTY-013
GTY-185	23.5	19.3	70	OMU-GTY-014
GTY-240	26	21.2	75	OMU-GTY-015
GTY-300	30	24	80	OMU-GTY-016
GTY-400	34	27.6	85	OMU-GTY-017
GTY-500	38	31.6	90	OMU-GTY-018
GTY-630	45	37.6	95	OMU-GTY-019

These products are applicable for the connection of the circular wire, hemicycle wire with power supply cable in distribution equipment, they are made of higher 99.9 percents T2 copper tube, and its surface is coated tin.