

Electric Power Fittings

Copper Cable Terminals Non-Isolated - JG Type

OUMO PUBLISH

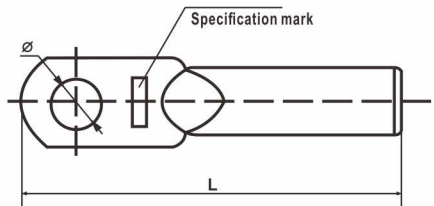
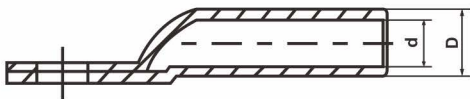

Specifications	Dimensions(mm)				Code No.
	D	d	Φ	L	
JG-10	8	6.6	Φ6.2, Φ8.2,	32	OMU-JG-001
JG-16	9	7	Φ6.2, Φ8.2, Φ10.5	39	OMU-JG-002
JG-25	9	7	Φ6.2, Φ8.2, Φ10.5, 12.5	41	OMU-JG-003
JG-35	10.5	8.5	Φ6.2, Φ8.2, Φ10.5, Φ12.5	46	OMU-JG-004
JG-50	12	9.8	Φ8.2, Φ10.5, Φ12.5	52	OMU-JG-005
JG-70	14.5	11.9	Φ8.2, Φ10.5, Φ12.5	55	OMU-JG-006
JG-95	16	13	Φ10.5, Φ12.5	62	OMU-JG-007
JG-120	19	15.4	Φ12.5, Φ16.5	66	OMU-JG-008
JG-150	20.5	16.7	Φ12.5, Φ16.5	73	OMU-JG-009
JG-185	23.5	19.3	Φ16.5	80	OMU-JG-010
JG-240	26	21.2	Φ16.5	86	OMU-JG-011
JG-300	30	24	Φ16.5, Φ20.5	94	OMU-JG-012
JG-400	34	27.6	Φ16.5, Φ20.5	103	OMU-JG-013
JG-500	38	31.6	Φ16.5, Φ20.5	113	OMU-JG-014
JG-630	45	37.6	Φ20.5	124	OMU-JG-015

These products are applicable to the connection of wires in distribution equipment power supply cable with electronic apparatus. It is made of T2 copper tube by die cast and coated tin.