

Electric Power Fittings

Copper Cable Terminals Non-Isolated - JGB Type

OUOMO PUBLISH

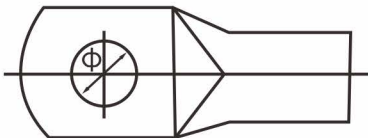
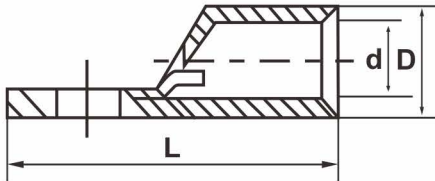

Specifications	Dimensions(mm)				Code No.
	D	d	Φ	L	
JGB-1.5	3.5	2.1	Φ4.2, Φ5.2	18	OMU-JGB-001
JGB-2.5	4	2.6	Φ4.2, Φ5.2, Φ6.2	19	OMU-JGB-002
JGB-4	4.8	3.4	Φ5.2, Φ6.2	21	OMU-JGB-003
JGB-6	5.5	4.1	Φ5.2, Φ6.2, Φ8.2	24	OMU-JGB-004
JGB-10	6.5	5.1	Φ6.2, Φ8.2	28	OMU-JGB-005
JGB-16	8	6.4	Φ6.2, Φ8.2, Φ10.5	33	OMU-JGB-006
JGB-25	9	7	Φ6.2, Φ8.2, Φ10.5	36	OMU-JGB-007
JGB-35	10.5	8.5	Φ6.2, Φ8.2, Φ10.5, Φ12.5	42	OMU-JGB-008
JGB-50	12	9.8	Φ8.2, Φ10.5, Φ12.5	49	OMU-JGB-009
JGB-70	14.5	11.9	Φ8.2, Φ10.5, Φ12.5	55	OMU-JGB-010
JGB-95	16	13	Φ10.5, Φ12.5	60	OMU-JGB-011
JGB-120	19	15.4	Φ12.5, Φ16.5	67	OMU-JGB-012
JGB-150	20.5	16.7	Φ12.5, Φ16.5	73	OMU-JGB-013
JGB-185	23.5	19.3	Φ16.5	78	OMU-JGB-014
JGB-240	26	21.2	Φ16.5	92	OMU-JGB-015
JGB-300	30	24	Φ16.5, Φ20.5	102	OMU-JGB-016
JGB-400	34	27.6	Φ16.5, Φ20.5	113	OMU-JGB-017
JGB-500	38	31.6	Φ16.5, Φ20.5	123	OMU-JGB-018
JGB-630	45	37.6	Φ20.5	145	OMU-JGB-019

These products are suitable for the connection of copper conductors (section 1.5-1000mm²) in power cables with electronic equipment. They are made of higher 99.9% pure copper tube T2 and coated with tin. Their working temperature is -55°C to 150°C.